



FULL HD 1080P/720P AHD CCTV CAMERAS

UPGRADING YOUR CONVENTIONAL CCTV CAMERAS TO FULL HD

UNIFORE AHD Camera Solutions

Professional Cameras with Advanced Imaging Functionality

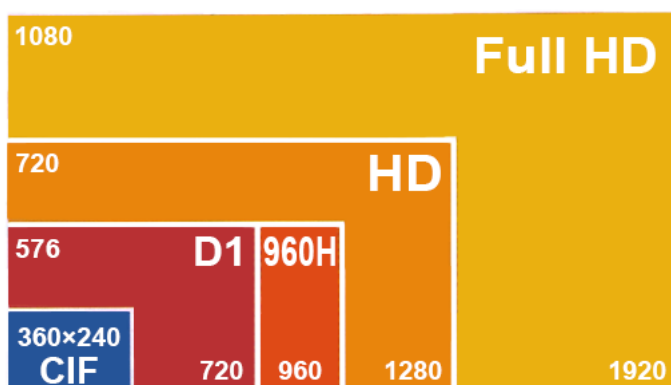

AHD is a new HD solution, AHD technology can transmit video signal over traditional coaxial cable up to 500 meters; it adopts advanced Y/C signal separation and analog signal filtering technology, which can effectively reduce color noise, and with better image reproduction. Compared with traditional analog cameras, AHD technology has significant improvement on imaging. Similar to IP camera, AHD's maximum video resolution can reach up to 1080P.

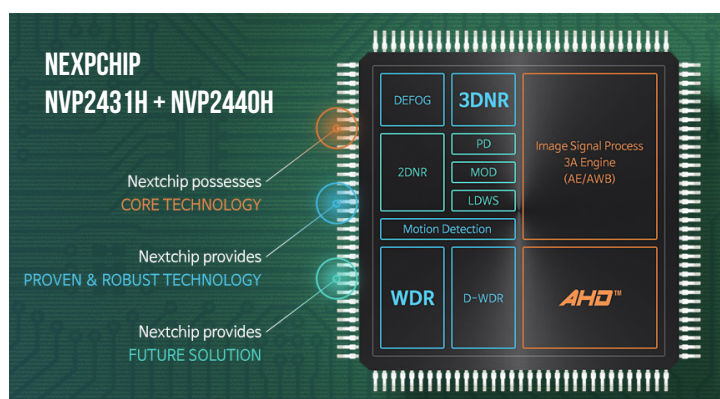
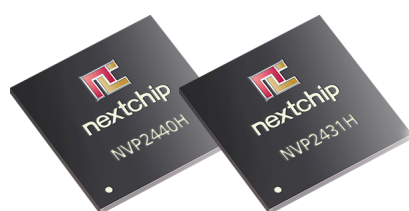

AHD cameras advantages:

- High resolution - Advanced signal filtering, 3D noise reduction, higher image resolution, better image reproduction.
- Long range transmission distance - max. 500 meters over traditional 75-3 coaxial cable.
- No video latency - Uncompressed video, real time transmitting
- Better compatibility - Compatible with D1/960H products.
- Easy to install - Support OSD menu, easy to operate and install
- Low cost - Same price like traditional analog camera, but high definition image quality.
- Open standard - AHD chip-set from third-party provider - Nextchip. Its standard is open for every security manufacturers.

MODEL: AHD-F720P/960P/1080P

1.0/1.3/2.0Megapixel 1080P Weatherproof AHD IR-Bullet Camera

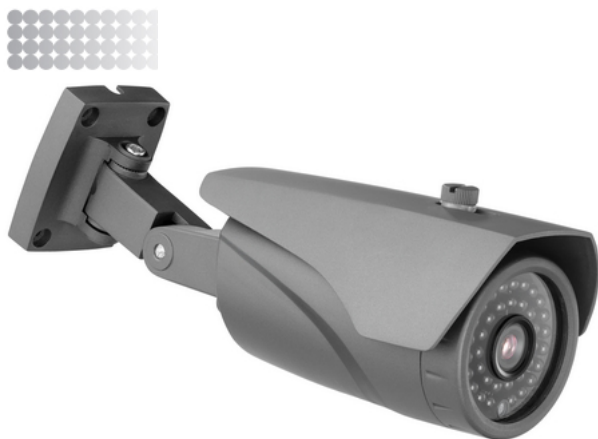

Model	AHD-F720P	AHD-F960P	AHD-F1080P
CMOS type	OmniVision	ON Semiconductor	Panasonic
CMOS model	1/4" OV9712	1/3" AR0130	1/3" MN34227
Image output	1280x720	1280x960	1920x1080
Min. Illumination	0.01Lux/0Lux	0.01Lux/0Lux	0.001Lux/0Lux
Lens	3.6mm fixed megapixel lens with IR cut filter		
Shutter Speed	1/60Sec 1/100,000Sec, Shutter Speed Adjustable		
Day/Night	Auto(ICR) / Color / B/W		
S/N ratio	>50dB		
Gamma correction	>0.45		
Sync. system	internal		
Infrared	36pcs F5 Infrared LEDs		
IR Range	30 meters		
ISP	NVP2431H	NVP2431H	NVP2440H
Noise Reduction	2D/3D noise reduction		
OSD Menu	Optional		
Power Supply	DC12V±10%		
Power Consumption	Max 4.0W		
Working Environment	-30°C~+60°C / Less than 95%RH (no condensation)		
Transmission Distance	Over 500m via 75-3 coaxial cable		
Ingress Protection	IP66		
Dimension	191.5mm x 80mm x 72mm		

Features

- IR Distance 25-30 meters
- 36pcs F5 black Infrared illuminators
- Standard 3.6mm lens, 6mm optional
- Dual-glasses, no IR reflection/fog
- Day/Night(ICR), AWB, AGC, BLC, 3D-DNR
- 3-axis bracket, IP67 weatherproof
- White/Grey color
- OSD menu optional

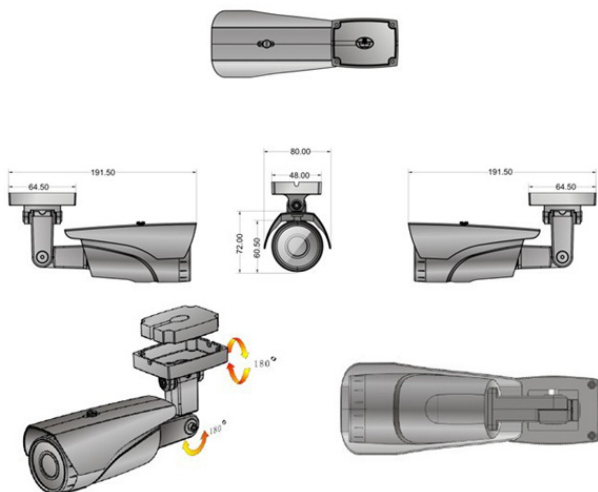

MODEL: AHD-B720P/960P/1080P

1.0/1.3/2.0Megapixel 1080P Weatherproof AHD IR-Bullet Camera



Model	AHD-B720P	AHD-B960P	AHD-B1080P
CMOS type	OmniVision	ON Semiconductor	Panasonic
CMOS model	1/4" OV9712	1/3" AR0130	1/3" MN34227
Image output	1280x720	1280x960	1920x1080
Min. Illumination	0.01Lux/0Lux	0.01Lux/0Lux	0.001Lux/0Lux
Lens	2.8-12mm vari-focal lens with IR-CUT filter		
Shutter Speed	1/60Sec 1/100,000Sec, Shutter Speed Adjustable		
Day/Night	Auto(ICR) / Color / B/W		
S/N ratio	>50dB		
Gamma correction	>0.45		
Sync. system	internal		
Infrared	42pcs F5 Infrared LEDs		
IR Range	40 meters		
ISP	NVP2431H	NVP2431H	NVP2440H
Noise Reduction	2D/3D noise reduction		
OSD Menu	Optional		
Power Supply	DC12V±10%		
Power Consumption	Max 6.5W		
Working Environment	-30°C~+60°C / Less than 95%RH (no condensation)		
Transmission Distance	Over 500m via 75-3 coaxial cable		
Ingress Protection	IP66		
Dimension	273mm (L) x 97mm (W) x 90mm (H)		

Features

- IR Distance 35-40 meters
- 42pcs F5 black Infrared illuminators
- 2.8-12mm varifocal lens
- Dual-glasses, no IR reflection/fog
- Day/Night(ICR), AWB, AGC, BLC, 3D-DNR
- 3-axis bracket, IP67 weatherproof
- White/Grey color
- OSD menu optional

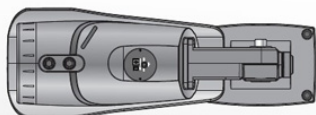
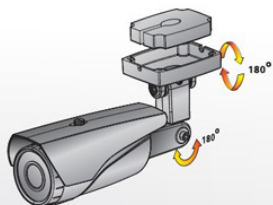
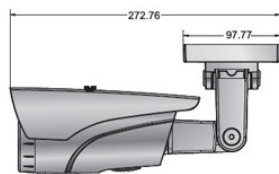
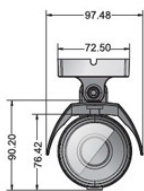

MODEL: AHD-B720P/960P/1080P

1.0/1.3/2.0Megapixel 1080P Weatherproof AHD IR-Bullet Camera



Model	AHD-B720P	AHD-B960P	AHD-B1080P
CMOS type	OmniVision	ON Semiconductor	Panasonic
CMOS model	1/4" OV9712	1/3" AR0130	1/3" MN34227
Image output	1280x720	1280x960	1920x1080
Min. Illumination	0.01Lux/0Lux	0.01Lux/0Lux	0.001Lux/0Lux
Lens	2.8-12mm varifocal lens with IR cut filter		
Shutter Speed	1/60Sec 1/100,000Sec, Shutter Speed Adjustable		
Day/Night	Auto(ICR) / Color / B/W		
S/N ratio	>50dB		
Gamma correction	>0.45		
Sync. system	internal		
Infrared	42pcs F5 Infrared LEDs		
IR Range	40 meters		
ISP	NVP2431H	NVP2431H	NVP2440H
Noise Reduction	2D/3D noise reduction		
OSD Menu	Optional		
Power Supply	DC12V±10%		
Power Consumption	Max 6.5W		
Working Environment	-30°C~+60°C / Less than 95%RH (no condensation)		
Transmission Distance	Over 500m via 75-3 coaxial cable		
Ingress Protection	IP66		
Dimension	369mm x 134mm		

Features

- IR Distance 35-40 meters
- 42pcs F5 black Infrared illuminators
- 2.8-12mm vari-focal lens
- Dual-glasses, no IR reflection/fog
- Day/Night(ICR), AWB, AGC, BLC, 3D-DNR
- 3-axis bracket, IP67 weatherproof
- White/Grey color
- OSD menu optional

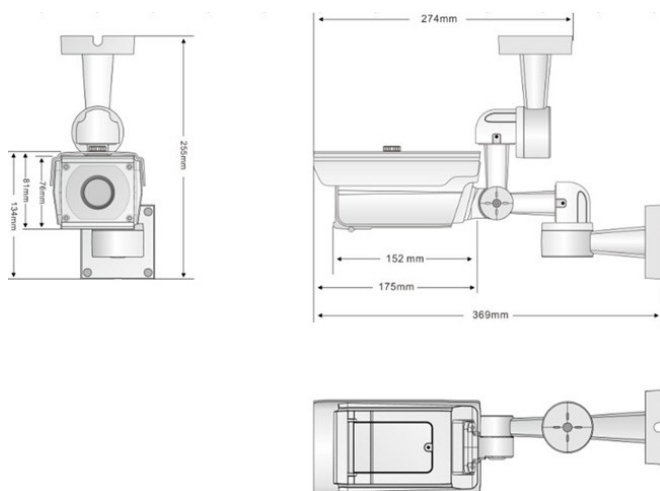

MODEL: AHD-MD720P/960P/1080P

1.0/1.3/2.0Megapixel 1080P Mini Dome Camera



Model	AHD-MD720P	AHD-MD960P	AHD-MD1080P
CMOS type	OmniVision	ON Semiconductor	Panasonic
CMOS model	1/4" OV9712	1/3" AR0130	1/3" MN34227
Image output	1280x720	1280x960	1920x1080
Min. Illumination	0.01Lux/0Lux	0.01Lux/0Lux	0.001Lux/0Lux
Lens	3.6mm fixed megapixel lens with IR cut filter		
Shutter Speed	1/60Sec 1/100,000Sec, Shutter Speed Adjustable		
Day/Night	Auto(ICR) / Color / B/W		
S/N ratio	>50dB		
Gamma correction	>0.45		
Sync. system	internal		
Infrared	24pcs F5 Infrared LEDs		
IR Range	20 meters		
ISP	NVP2431H	NVP2431H	NVP2440H
Noise Reduction	2D/3D noise reduction		
OSD Menu	Optional		
Power Supply	DC12V±10%		
Power Consumption	Max 4.5W		
Working Environment	-30°C~+60°C / Less than 95%RH (no condensation)		
Transmission Distance	Over 500m via 75-3 coaxial cable		
Ingress Protection	N/A		
Dimension	112mm x 92mm		

Features

- IR Distance 15-20 meters
- 24pcs F5 black Infrared illuminators
- Standard 3.6mm lens, 6mm optional
- Dual-glasses, no IR reflection/fog
- Day/Night(ICR), AWB, AGC, BLC, 3D-DNR
- Inner 3-Axis bracket
- OSD menu optional

MODEL: AHD-ME720P/960P/1080P

1.0/1.3/2.0Megapixel 1080P Mini Dome Camera



Model	AHD-ME720P	AHD-ME960P	AHD-ME1080P
CMOS type	OmniVision	ON Semiconductor	Panasonic
CMOS model	1/4" OV9712	1/3" AR0130	1/3" MN34227
Image output	1280x720	1280x960	1920x1080
Min. Illumination	0.01Lux/0Lux	0.01Lux/0Lux	0.001Lux/0Lux
Lens	3.6mm fixed megapixel lens with IR cut filter		
Shutter Speed	1/60Sec 1/100,000Sec, Shutter Speed Adjustable		
Day/Night	Auto(ICR) / Color / B/W		
S/N ratio	>50dB		
Gamma correction	>0.45		
Sync. system	internal		
Infrared	30pcs F5 Infrared LEDs		
IR Range	30 meters		
ISP	NVP2431H	NVP2431H	NVP2440H
Noise Reduction	2D/3D noise reduction		
OSD Menu	Optional		
Power Supply	DC12V±10%		
Power Consumption	Max 4.5W		
Working Environment	-30°C~+60°C / Less than 95%RH (no condensation)		
Transmission Distance	Over 500m via 75-3 coaxial cable		
Ingress Protection	N/A		
Dimension	132mmx108mm		

Features

- Indoor dome camera
- 720P/960P/1080P resolution
- long distance real-time transmission
- IR distance 30 meters
- Standard 2.8-12mm varifocal lens
- Dual-glasses, no IR reflection/fog
- Day/Night(ICR), AWB, AGC, BLC, 3D-DNR
- Inner 3-axis bracket
- OSD menu optional

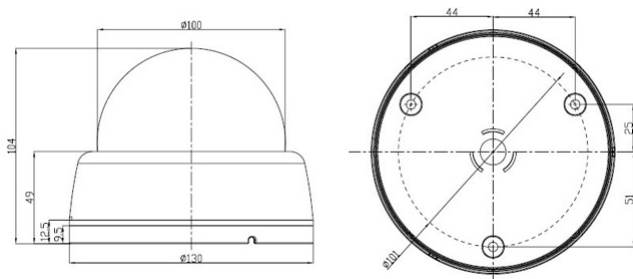

MODEL: AHD-MF720P/960P/1080P

1.0/1.3/2.0Megapixel 1080P Vandal-proof Dome Camera



Model	AHD-MF720P	AHD-MF960P	AHD-MF1080P
CMOS type	OmniVision	ON Semiconductor	Panasonic
CMOS model	1/4" OV9712	1/3" AR0130	1/3" MN34227
Image output	1280x720	1280x960	1920x1080
Min. Illumination	0.01Lux/0Lux	0.01Lux/0Lux	0.001Lux/0Lux
Lens	3.6mm fixed megapixel lens with IR cut filter		
Shutter Speed	1/60Sec 1/100,000Sec, Shutter Speed Adjustable		
Day/Night	Auto(ICR) / Color / B/W		
S/N ratio	>50dB		
Gamma correction	>0.45		
Sync. system	internal		
Infrared	36pcs F5 Infrared LEDs		
IR Range	30 meters		
ISP	NVP2431H	NVP2431H	NVP2440H
Noise Reduction	2D/3D noise reduction		
OSD Menu	Optional		
Power Supply	DC12V±10%		
Power Consumption	Max 4.5W		
Working Environment	-30°C~+60°C / Less than 95%RH (no condensation)		
Transmission Distance	Over 500m via 75-3 coaxial cable		
Ingress Protection	IP66		
Dimension	140mmx120mm		

Features

- Vandal-proof outdoor dome camera
- 720P/960P/1080P resolution
- Long distance real-time transmission
- IR Distance 30 meters
- 36pcs F5 black Infrared illuminators
- 2.8-12mm vari-focal lens
- Dual-glasses, no IR reflection/fog
- Day/Night(ICR), AWB, AGC, BLC, 3D-DNR
- Inner 4-axis bracket, IP67 weatherproof
- OSD menu optional
- IP66, IK10, DC12V

